

Installation guidelines

LEAFIELD Bollards

Anti-ram



Cleaning Products should be flushed with clean water and then washed with a mild detergent solution using a bristle brush or sponge. Care should be taken not to apply undue pressure that may damage labels. Flush clean with water after washing.



Manufacturing Standard (as applicable)

All LEAFIELD Environmental products are manufactured to BS EN ISO 9002.

Plastic materials: Mechanical properties tested to BS 2782

Hot dipped galvanized: BS 729

Powder coating: BS 3900 Zinc coating: BS 1706



Tools Digging equipment, Concrete mixing equipment, Hammer drill, 6mm HSS drill bit, Provided: Allen key



PPE Always wear appropriate PPE equipment and follow safety guide lines

Preparation

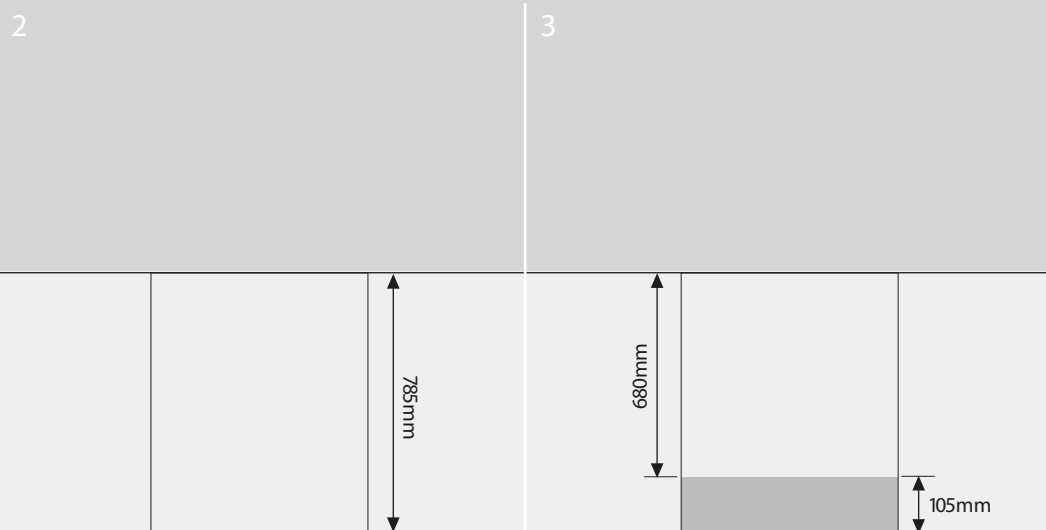

LEAFIELD anti-ram bollards come in two parts Polyethylene outer and steel core

Dig a hole 450mm square x 785mm deep

Bed hole with type 1 infill and compact



Check site for buried services.

Ensure site is protected from pedestrian / vehicle access in accordance with New roads and Streetworks act 1991

Components supplied as standard

Chassis clip



X3

Grub screws



X2

Plug



X2



Installation in concrete

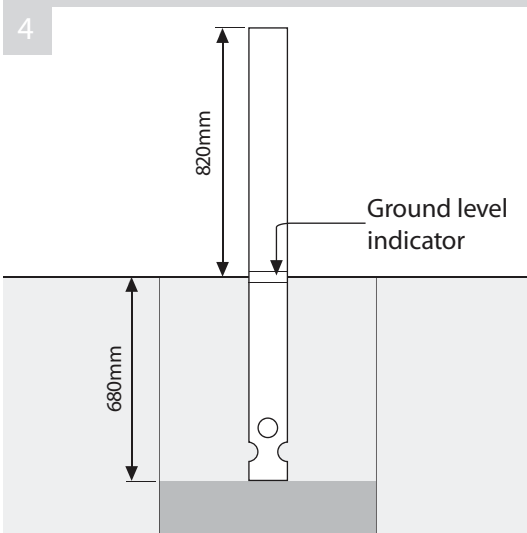

Sit the steel core onto the infill. Make sure the bottom set of lines marked on the core are at ground level

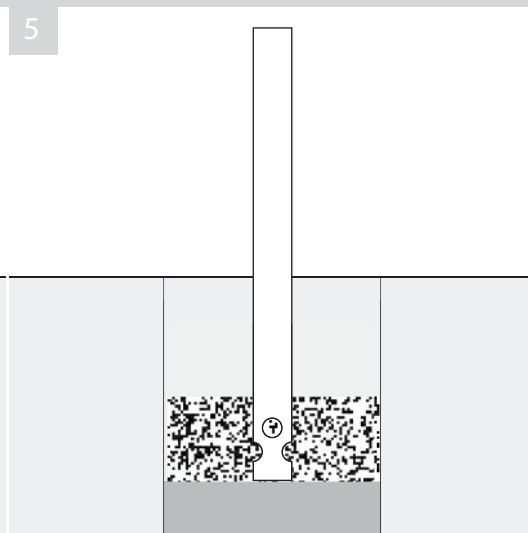

Checking the core is vertical partially fill hole with C20 concrete mix

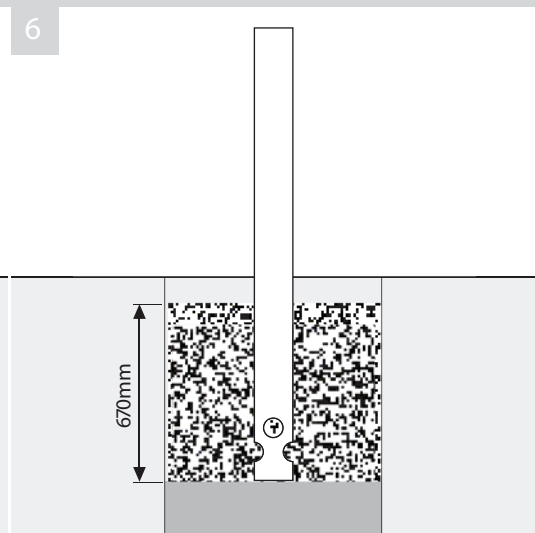

Continue to fill hole with C20 concrete mix until 100mm below ground level

Placing bollard over core



When concrete has cured replace final wearing course to ground level



Equally space the three spring clips around the top edge of the core. Ensure the long leg of the clip is located on the outside of the tube



Slide bollard over steel core to ground level. If fitted with reflective banding orientate so that red faces into the direction of traffic flow

Locking bollard position



With bollard at final resting level remove one plug. Using bollard screw port as a guide drill a 6mm hole through the steel core



Using allen key screw in a grub screw through the threaded port in the bollard and into the core

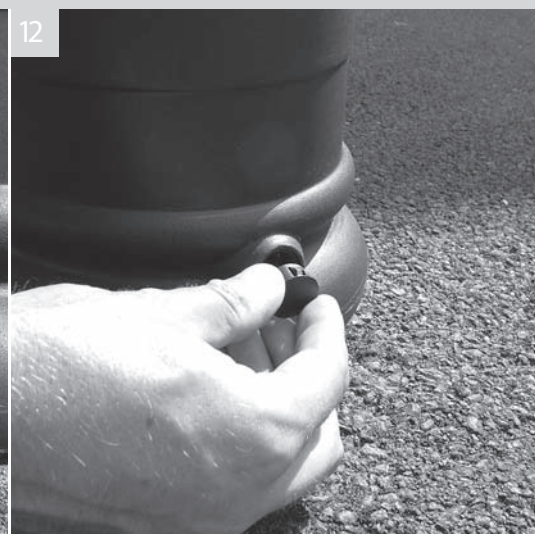

Replace plug. Repeat steps 10 - 12 removing the plug from the opposite side of the bollard



post
Leaffield Way, Leaffield Industrial Estate
Corsham, Wiltshire SN13 9UD



telephone
+ 44 (0)1225 816500



facsimile
+ 44 (0)1225 816501



website/email
www.leaffield-environmental.com
envinfo@leaffield-environmental.com

